

## Waterproof pre-insulated hexagonal compression connectors

### Application

These pre-insulated connectors are suitable for insulated stranded aluminium conductors. Three connector versions are available to meet the mechanical load requirements for self-supporting system and systems with a neutral messenger.

Stripped cables are inserted up to the block in the connector. Crimping according to the marks with appropriate crimping die over the insulation. The electrical contact and the sealing by the elastomeric ring are achieved during the crimp process. Uniform connector length of 100 mm, except for neutral messengers 170 mm.

### Features

- Suitable for stranded aluminium conductors
- Tested for water tightness at a voltage of 6 kV for 30 min in a waterbath (NFC 33020, EN 50483-4 class 1)
- Only two crimping die sizes (E173, E215) cover complete connector range (tools and dies see pages 51 and 52)
- Exceeds requirements according to EN 50483-4 class 1 and NFC 33021
- A colour code of elastomeric sealing ring allows an easy identification of the cross sections
- Inner aluminium sleeve filled with contact grease
- Insulation material made of weather and UV resistant polymer

Mechanical load withstand of connectors:

- For conductors of self-supporting system: 85 % of conductor breaking load
- For systems with neutral messenger: 60 % of breaking load of phase conductor 95 % of breaking load of insulated neutral conductor



Type: MJPT

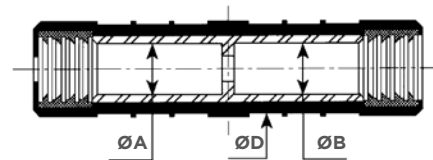

	Conductor cross section (mm <sup>2</sup> )	Colour code A/B	Dimensions (mm)			Crimp die size	Weight (kg/100 pcs)
			ØA	ØB	ØD		
<b>For self supporting LV-ABC systems</b>							
MJPT 16	16	blue	5.5	5.5	20	E173	5.5
MJPT 25 Alus	25	orange	6.5	6.5	20	E173	5.5
MJPT 35 Alus	35	red	–	–	–	E173	5.5
MJPT 50 Alus	50	yellow	9.0	9.0	20	E173	5.0
MJPT 70 Alus	70	white	10.5	10.5	20	E173	4.5
MJPT 95 Alus	95	grey	12.2	12.2	25	E215	7.5
MJPT 120 Alus	120	pink	14.2	14.2	25	E215	7.5
<b>For phase conductors of LV-ABC systems with neutral messenger</b>							
MJPT 16	16	blue	5.5	5.5	20	E173	5.5
MJPT 25	25	orange	6.5	6.5	20	E173	5.0
MJPT 35	35	red	8.0	8.0	20	E173	5.0
MJPT 35-25	35 – 25	red/orange	8.0	6.5	20	E173	5.0
MJPT 50	50	yellow	9.0	9.0	20	E173	5.0
MJPT 50-25	50 – 25	yellow/orange	9.0	6.5	20	E173	5.0
MJPT 50-35	50 – 35	yellow/red	9.0	8.0	20	E173	5.0
MJPT 70	70	white	10.5	10.5	20	E173	4.5
MJPT 70-35	70 – 35	white/red	10.5	8.0	20	E173	4.5
MJPT 70-50	70 – 50	white/yellow	10.5	9.0	20	E173	4.5
MJPT 95	95	grey	12.2	12.2	20	E173	4.0
MJPT 95-35	95 – 35	grey/red	12.2	8.0	20	E173	4.5
MJPT 95-50	95 – 50	grey/yellow	12.2	9.0	20	E173	4.0
MJPT 95-70	95 – 70	grey/white	12.2	10.5	20	E173	4.0
MJPT 120 D25	120	pink	14.2	14.2	25	E215	8.5
MJPT 150	150	violet	15.5	15.5	25	E215	8.0
MJPT 150-70	150 – 70	violet/white	15.5	10.5	25	E215	9.0
MJPT 150-95	150 – 95	violet/grey	15.5	12.2	25	E215	9.0
<b>For insulated neutral conductors of LV-ABC systems with neutral messenger</b>							
MJPT 54	54.6	black	10.0	10.0	20	E173	8.0
MJPT 70N	70	white	10.5	10.5	20	E173	8.0
MJPT 70N-54	70 – 54.6	white/black	10.5	10.0	20	E173	8.0